

Pond Cleaner

Instructions

BERMUDA

OPTION A - BRUSH HEAD CLEANER - ASSEMBLY INSTRUCTIONS

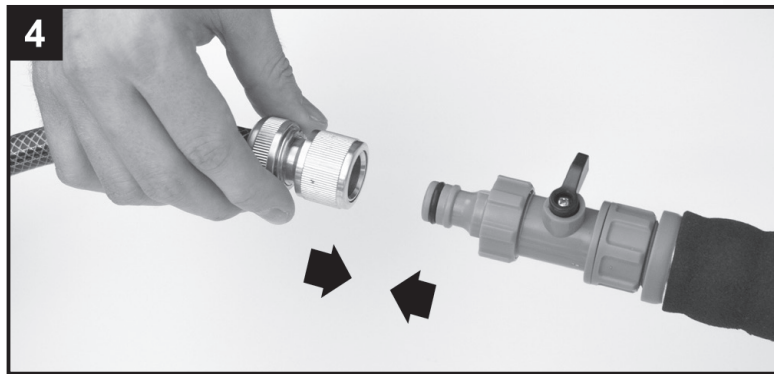
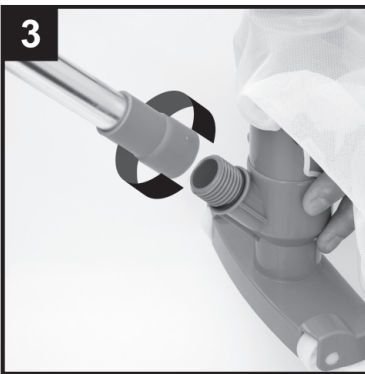
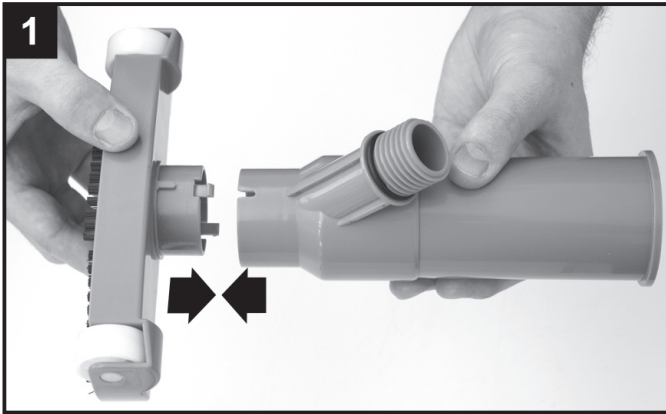

Once assembled and connected to the garden hose, place the vacuum cleaner in the area that requires cleaning and turn the tap on, adjusting to control pressure and the resulting suction. The efficiency of the Vacuum is dependant on your water pressure. If the pressure drops below 5psi the suction will not be as effective.

Please Note: For the vacuum to work the cleaner head must be fully submerged.

OPTION B - SKIMMER NET HEAD - ASSEMBLY INSTRUCTIONS



WARRANTY

This product is guaranteed against defects in material and workmanship for one year from the date of purchase, under normal usage. Return the product to the place of purchase if a fault occurs, with valid proof of purchase. This guarantee is not transferable and does not affect your statutory rights. Evolution Aqua, Bermuda, its distributors and dealers shall not be held liable for any consequential loss as a result of using this product.

