

BERMUDA



Pondi Vacuum Cleaner

Instruction Manual

IMPORTANT: Please read this instruction manual carefully before using this product. Keep the manual safe for future reference.

Thank you for purchasing a Bermuda Pondi Vacuum Cleaner. Bermuda Pondi Vacuum Cleaner makes cleaning your pond or water feature as easy as it can be. The multi-purpose pond vac can be used in wet or dry applications to remove sludge, algae, and other particles from the pond, and also in blow mode. The pond vac has a powerful 1400 Watt motor and is on wheels for easy manoeuvrability. Nozzles and accessories are also supplied.

Please read this instruction manual and keep it safe.

Attention

- Keep out of reach of children
- Before cleaning or maintaining the appliance, the power plug must be removed from the socket.
- Check all the accessories before connecting them to make sure they are in the correct position and there are no any defects.
- Never use to collect:
 - combustible liquids or explosive materials
 - powders that can set solid with water, such as cement
- Do not block the inlet as this make cause the motor to overheat.
- Do not turn the vacuum over in case water goes into the motor.
- Do not store in direct sunlight or in high temperatures.
- Do not immerse the lid in water as you will damage the motor and electrical parts. Use a cloth to wipe the motor if needed.
- Do not pull with the cable.
- Make sure the foam filter cover is fitted over the motor inside the barrel before operating the vacuum.



Components

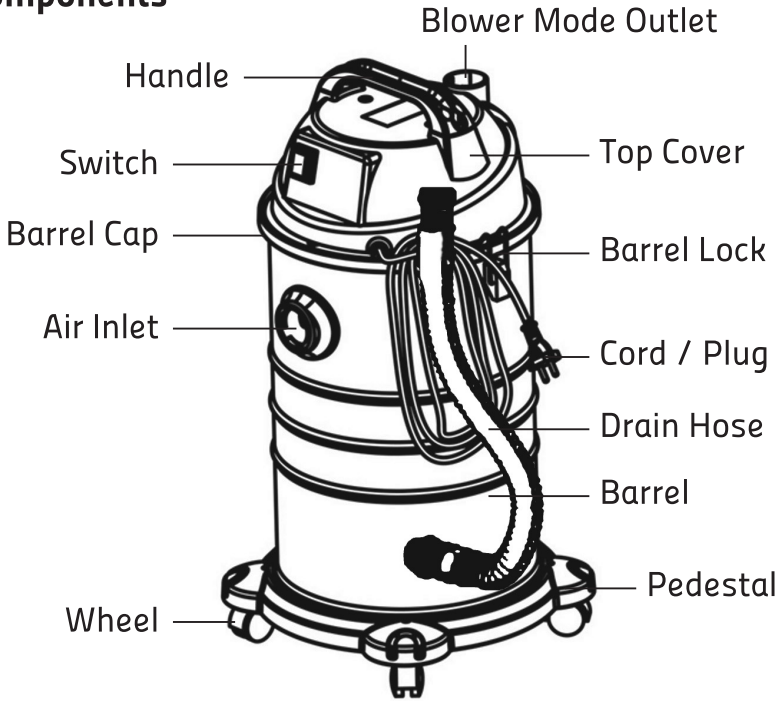

Hose

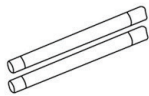

Tubes



Floor
Brush



Crevice
Nozzle



Filter
Bag



Round
Brush



Drain
Hose

Specifications

Power	Voltage	Frequency	Cable length
1400W	220V - 240V	50/60Hz	4.5m

Assembly

- Insert the hose connector into the air inlet. Line up the thread with the notches and turn the connector anti-clockwise until it is tightly fastened.
- Press the connector button and pull the connector out when you want to pull hose connector out of the vacuum.
- Insert hose connector into the blower mode outlet when you want to use the blowing function.
- Ensure foam filter bag is fitted to motor inside the barrel.

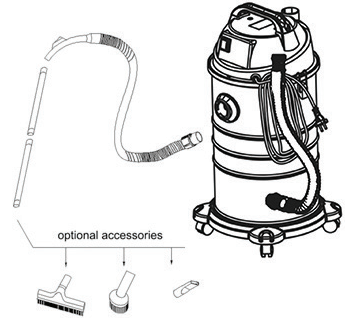

Wet / Dry Mode Set-Up

Power switch settings

- 0 Vacuum is off
- I Vacuum is on

You can adjust the air flow by pushing the slider block up and down on the hose handle.



Blower Mode Set-Up

Protective cut-off device

The protective cut-off device will activate in the following circumstances:

- **When the barrel is full of water.** The suction will stop, however the motor will make a noise which indicates it is running at a high speed. You should turn the power off and clean out the water.
- **When the vacuum has overturned.** You should turn the power off and turn the vacuum back upright.
- **When the motor is damaged.** You should stop using the vacuum, turn off the power, clean any water out and check for damage.

Maintenance

Cleaning the barrel:

When the barrel is full of dust which causes suction decrease considerably, you turn off the power and clean the dust away from the barrel.

- 1) Unfasten the locking knob, lift up the top cover.
- 2) Take off the foam filter bag, clean the dust away in the dust barrel.
- 3) Install the foam filter bag back and place the top cover.

Cleaning the foam filter bag:

The foam filter bag should be washed in clean, warm water when it is covered with dust.

- 1) Take off the foam filter bag
- 2) Wash
- 3) Dry

Draining the vacuum:

The drain hose is connected to allow you to easily drain water from the vacuum.



Troubleshooting

Pondi Vacuum does not power up:

- Check the power supply
 - If power cord is damaged do not attempt to repair this
 - Check that power supply has not tripped
- Motor may be damaged
 - If so, do not attempt to repair this

Pondi Vacuum does not appear to be sucking:

- Check foam filter bag is not blocked
 - If it is dirty clean it as instructed
- Check tubes are not blocked
 - If they are blocked, undo tubes and clean them

Dust and dirt is building up inside the barrel:

- Remove the top cover, with the motor head, and then wash the inside of the barrel and leave to dry. **DO NOT WASH THE MOTOR.**

Guarantee

This product is guaranteed against defects in material and workmanship for **one year** from the date of purchase, under normal usage.

The guarantee **DOES NOT APPLY** in case of improper use, negligence, lack of maintenance or accidental damage to the product. If the product fails due to a manufacturing fault within this period it will be either repaired or replaced free of charge. Moving parts or wearable parts are not covered by the guarantee.

Should your Bermuda product stop working refer first to trouble shooting and if this does not help, return the product to the place of purchase.

Liability is limited to replacement of the faulty product only. No other costs will be reimbursed. This guarantee is not transferable and does not affect your statutory rights.

Do not attempt to tamper with or access electrical components inside. Doing so will invalidate the warranty.

The manufacturer or supplier shall not be responsible, or held liable for any damages caused by defective components or materials of this product, or for loss incurred by interruption of service, or any consequential/incidental damages and expenses arising from the production, sale use or misuse of this product or any other consequential loss.

Any warranty claim must be accompanied by a valid, dated proof of purchase. Evolution Aqua, Bermuda, its distributors and dealers shall not be held liable for any loss of fish, plants or any other livestock as a result of any failure or defect of this product.

The installation and use of your product outside of our recommendations as printed in this manual may also void the warranty.



www.bermudawatergardens.com

BERMUDA an Evolution Aqua brand.
Evolution House, Kellet Close, Wigan, Lancashire, WN5 0LP

DISTRIBUTED BY: Certikin International Ltd, Unit 4 Tungsten Park,
Colletts Way, Witney, OX29 0AX